

Verschlußschrauben mit Innensechskant (kegeliges Rohrgewinde)

Hexagon socket pipe plugs
(conical pipe thread)

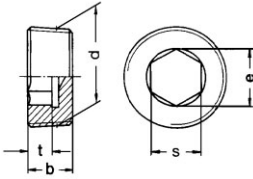

A 2 / A 4

| d | b | s | e | t min. | A 2 | A 4 |  |
|---------|----|----|------|--------|---------|---------|---|
| R 1/8 | 8 | 5 | 5,7 | 4 | 168,00 | 185,00 | 50 |
| R 1/4 | 10 | 7 | 8 | 5 | 215,00 | 236,00 | 50 |
| R 3/8 | 10 | 8 | 9,2 | 5 | 252,00 | 277,00 | 50 |
| R 1/2 | 10 | 10 | 11,4 | 5 | 365,00 | 401,00 | 25 |
| R 3/4 | 12 | 12 | 13,7 | 6 | 686,00 | 755,00 | 25 |
| R 1 | 12 | 17 | 19,4 | 6 | 1492,00 | 1642,00 | 10 |
| R 1 1/4 | 18 | 22 | 25,2 | 11,5 | 3855,00 | 4238,00 | 5 |
| R 1 1/2 | 20 | 24 | 27,4 | 11,5 | 4499,00 | 4949,00 | 5 |
| R 2 | 22 | 32 | 35,6 | 17 | 4627,00 | 5087,00 | 5 |

Preise/Prices... 100 Stück/pcs.

Bestellbeispiel/example for ordering: DIN 906 - A 2 - R 1/8"